

VILLAGE OF LUTHER

RECEIVED AND FILED
In Auditor General's Office,
May 8 1882
MAY 18 1882
M. G. W. G. R.
Dep. Aud. Genl.

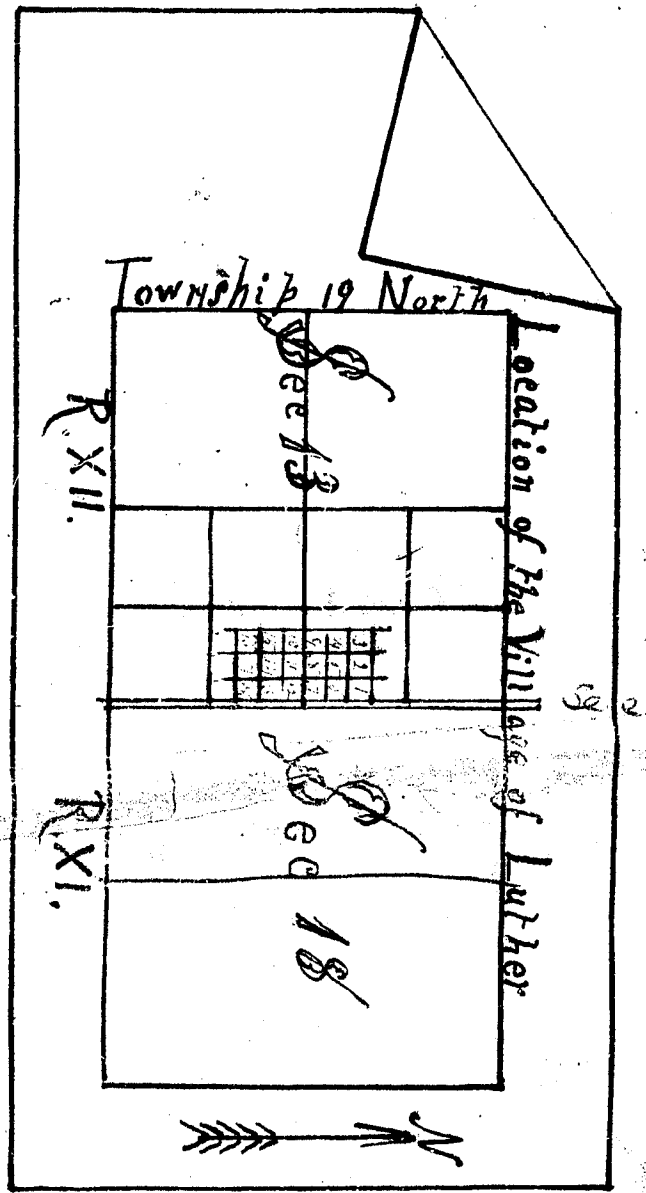

State of Michigan }
County of Lake }
I hereby certify that I have surveyed and plotted the Village of Luther that it is situated on the South East quarter of the South East quarter of Section 13 (13), Township 19 North (19) North, of Range Twelve (12) West, Michigan. That the above plot accurately represents the location on the land, that the survey was made with the same precision as the section line, by 1° 30' 00" S. 50' 00" W. the corner plat is made on a scale of 132 feet to one inch.
Spencer G. Brown
Surveyor for Lake County
March 4th 1882

State of Michigan }
County of Lake }
The execution of the annexed plat, }
I hereby acknowledge }
Spencer G. Brown }
Surveyor for Lake County }
1882

State of Michigan }
County of Lake }
On this 13th day of March in the year one thousand eight hundred and eighty two, before me a Justice of the Peace in and for said County, personally appeared William G. ... to me known to be the same person described and who executed the within instrument; who acknowledged the same to be his own free act and deed.

State of Michigan }
County of Lake }
No. This instrument was signed and sealed by the said ... and Charles S. ... of the County of Lake, Michigan, the said ... of the County of Lake, Michigan, and of the State of Michigan, in an exact duplicate thereof, and of the whole of the said plat.

Section 13 Township No 19 N. of Range 12 West Mich

Block	1	2	3	4	5	6	7
ASH ST.	1	2	3	4	5	6	7
OAK ST.	1	2	3	4	5	6	7
PINE ST.	1	2	3	4	5	6	7
BIRCH ST.	1	2	3	4	5	6	7
RIVER ST.	1	2	3	4	5	6	7
ELM ST.	1	2	3	4	5	6	7
LUTHER ST.	1	2	3	4	5	6	7
FRONT ST.	1	2	3	4	5	6	7
MAPLE ST.	1	2	3	4	5	6	7
SPRING ST.	1	2	3	4	5	6	7

15.66 Chains

Section Line

State of Michigan }
County of Lake }
I do hereby certify that the above plat was correctly compared with the original plat of the Village of Luther, now on file in the office of said Auditor General, and that it is a true and correct copy thereof, and of the whole of the same, as the same may appear by reference to the original plat of said Village of Luther, now on file in the office of said Auditor General.

VILLAGE OF LUTHER

RECEIVED AND FILED
In Auditor General's Office,
May 8 1882
Wm. A. Abbott
Dep. Aud. Genl.

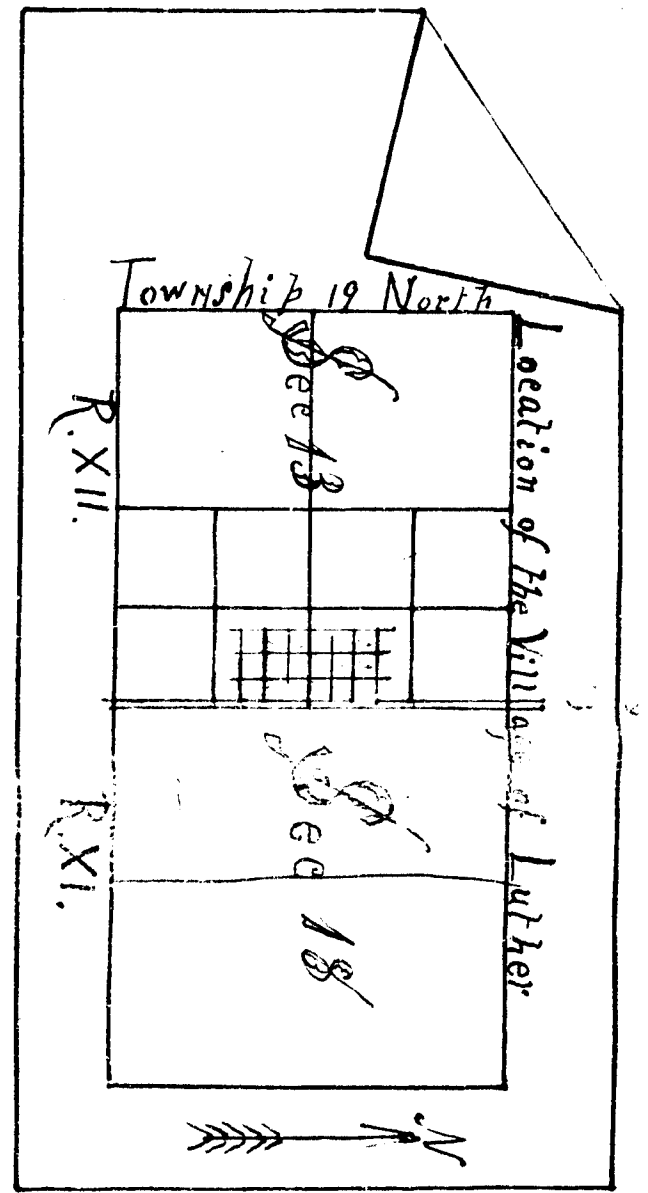

State of Michigan }
County of Jackson }
I hereby certify that I have reviewed and plotted the Village of Luther that it is situate on the South East quarter of the North East quarter of section thirteen (13), Township No. 19 North, of Range Twelve (12) North, Michigan. I find the above plot accurately represents the land, that the survey was made in full compliance with the act in that behalf made, as the section lines by 1834 & 1835 are correct and is made on a scale of 150 feet to the inch.
Witness my hand and seal of office at Lansing, Michigan, this 24th day of May 1882.

State of Michigan }
County of Jackson }
I hereby certify that I have reviewed the execution of the annexed plan, and find it correct.
Witness my hand and seal of office at Lansing, Michigan, this 24th day of May 1882.

State of Michigan }
County of Jackson }
On this 27th day of May 1882, in the year one thousand eight hundred and eighty two, before me a Justice of the Peace in and for the County of Jackson, Michigan, the within and above named William A. Abbott, known to be the same person who executed the within instrument, who acknowledges the same to be his own free act and deed.

State of Michigan }
County of Jackson }
I have understood and signed the foregoing Certificate of Survey, and I hereby certify that the same is correct and true in all particulars, and of the whole and effect thereof.
Witness my hand and seal of office at Lansing, Michigan, this 24th day of May 1882.

Section 13 Township No 19 N. of Range 12 West Mich

SPRING ST.		RIVER ST.		LUTHER ST.	
135 ft	135 ft	135 ft	135 ft	135 ft	135 ft
2	1	2	1	2	1
3	4	3	4	3	4
6	8	6	8	6	8
7	8	7	8	7	8
ASH ST.		PINE ST.		LUTHER ST.	
135 ft	135 ft	135 ft	135 ft	135 ft	135 ft
2	1	2	1	2	1
3	4	3	4	3	4
6	8	6	8	6	8
7	8	7	8	7	8
OAK ST.		BIRCH ST.		LUTHER ST.	
135 ft	135 ft	135 ft	135 ft	135 ft	135 ft
2	1	2	1	2	1
3	4	3	4	3	4
6	8	6	8	6	8
7	8	7	8	7	8
FRONT ST.		ELM ST.		LUTHER ST.	
135 ft	135 ft	135 ft	135 ft	135 ft	135 ft
2	1	2	1	2	1
3	4	3	4	3	4
6	8	6	8	6	8
7	8	7	8	7	8
FRONT ST.		MAPLE ST.		LUTHER ST.	
135 ft	135 ft	135 ft	135 ft	135 ft	135 ft
2	1	2	1	2	1
3	4	3	4	3	4
6	8	6	8	6	8
7	8	7	8	7	8

State of Michigan }
County of Jackson }
I have understood and signed the foregoing Certificate of Survey, and I hereby certify that the same is correct and true in all particulars, and of the whole and effect thereof.
Witness my hand and seal of office at Lansing, Michigan, this 24th day of May 1882.

Section Line STATE T. 15.66 Chains