

D. Elmer C. Sayles
Register of Deeds, for said County do hereby certify that the above and foregoing is a true and compared copy of an original Village Plat now on record in the office of the Register of Deeds of said County and the whole of such original record. In testimony whereof, I have hereunto set my hand and affixed the seal of said office, at the Village of Baldwin, this 8th day of December, A. D. 1903.
Elmer C. Sayles
Register of Deeds

SEAL

543 1/4

The Village of Chase

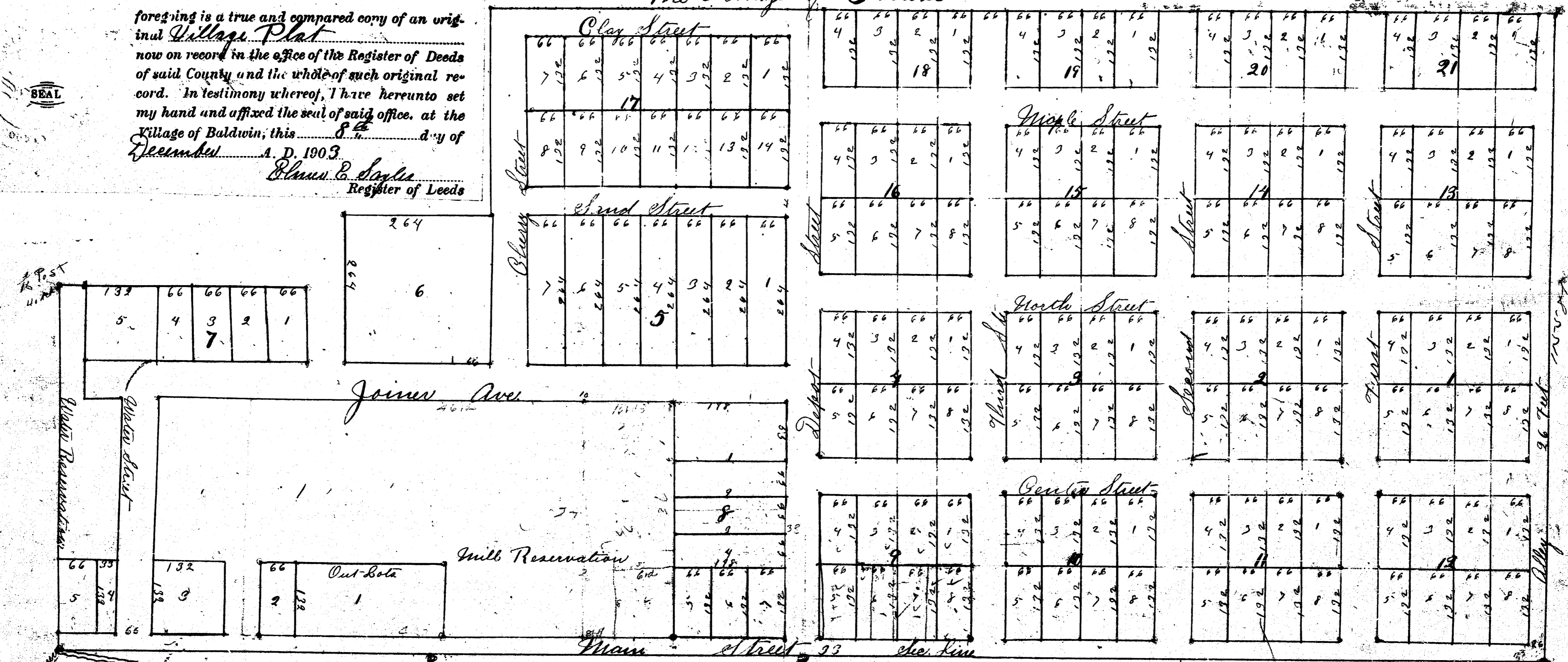

PROCURD AND FILED
ACT 186 LAWS 1895
IN AUDITOR GENERAL'S OFFICE
Dec 11, 1903
Tom H. ...
Deputy Auditor General

I hereby certify that I have surveyed and platted the Village of Chase, that it is situated on the South half of the South West Quarter of Sec. Four, in Town Seventeen North & Range eleven West in the County of Lake State of Michigan. That the above plat accurately represents its location on the land, its outlines and its subdivisions. That the survey was made with the same variation of compass, as the outline of the sec. viz 2° W. from Magnetic. That the plat was made on a scale of 132 feet to the inch.

State of Michigan, County of Lake, ss.
On this 12th day of August in the year of our Lord one thousand eight hundred & eighty one, came before me Charles W. Joiner who acknowledged that they were the joint owners of the South half of the South West quarter of Section Four (4) in Town Seventeen (17) North of Range eleven (11) West. That they caused the Village of Chase to be surveyed and Platted on the South part of it.

State of Michigan, County of Lake, ss.
We the undersigned Charles W. Joiner as Surveyor & Orland F. Phillips as Register of Deeds do hereby certify that we have carefully compared the annexed plat with the original plat of the Village of Chase in said County of Lake, that it is an exact duplicate thereof and the whole of such map or plat.

Witness our hands this 12th day of August A. D. 1881

C. W. Joiner Surveyor
Orland F. Phillips Register of Deeds

C. W. Joiner - [Seal]
Orland F. Phillips - [Seal]

Register of Deeds } as
County of Lake }
Received for record the 12th day of August A. D. 1881
at 3 o'clock P.M.
Orland F. Phillips Register

1881

Edmund C. Saylor

Register of Deeds for said County do hereby certify that the above and foregoing is a true and compared copy of an original Village Plat now on record in the office of the Register of Deeds of said County and the whole of such original record. In testimony whereof, I have hereunto set my hand and affixed the seal of said office, at the Village of Baldwin, this 8th day of December A. D. 1903.



Edmund C. Saylor
 Register of Deeds

1431

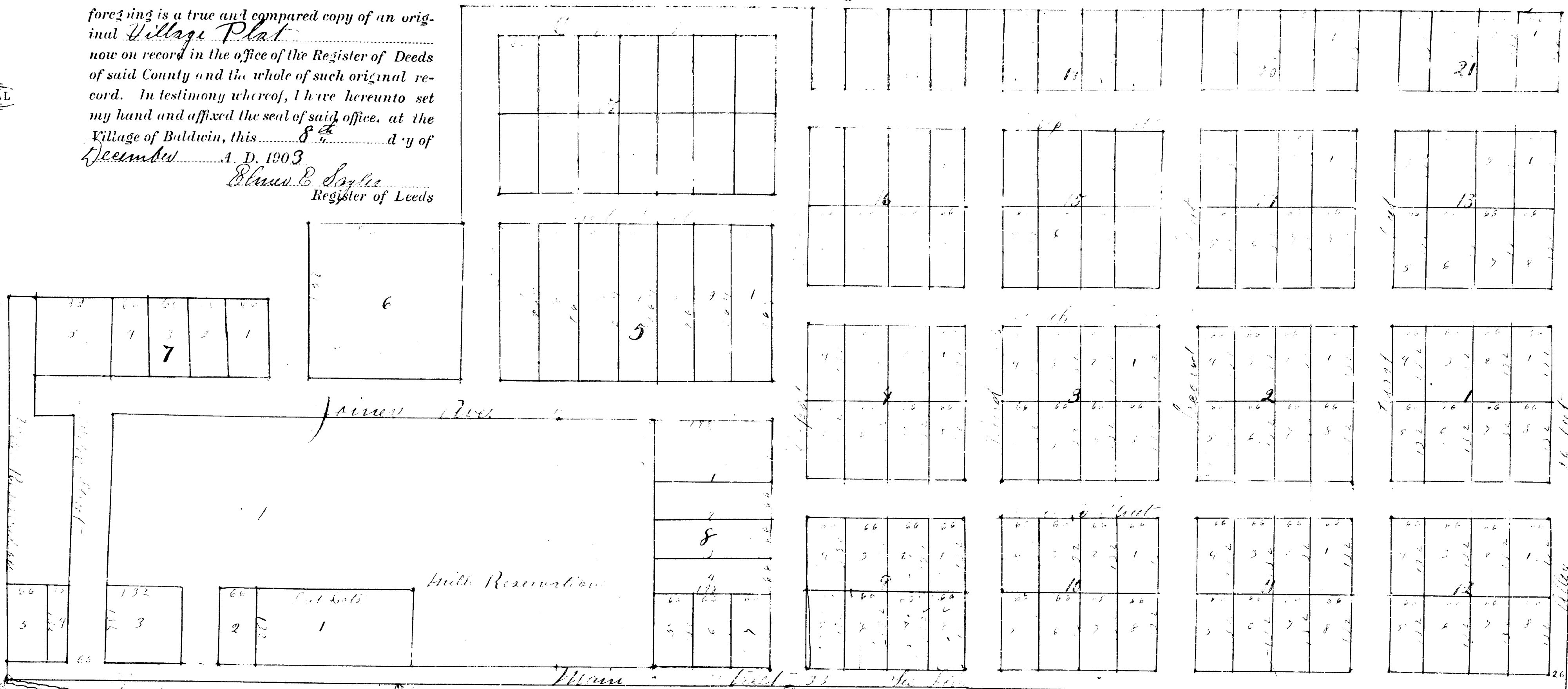

PROCURED AND FILED
 ACT 136 LAWS 1895
 IN AUDITOR GENERAL'S OFFICE

Dec 11, 1903
John H. ...
 Deputy Auditor General.

I hereby certify that I have surveyed and platted the Village of Chase. That it is situated on the South half of the South West Quarter of Sec. Four, in town Seventeen North & Range eleven West in the County of Lake State of Michigan. That the above plat accurately represents its location on the land, its outlines and its subdivisions. That the survey was made with the same variation of compass, as the outlines of the sec. viz 2° W. from magnetic. That the plat was made on a scale of 132 feet to the inch.

State of Michigan County of Lake } ss.
 On this 12th day of August in the year of our Lord one thousand eight hundred & eighty one, came before me Charles W. Joiner who acknowledged that they were the joint-owners of the South half of the South West quarter of Section Four (4) in Town Seventeen (17) North & Range eleven (11) West. That they caused the Village of Chase to be surveyed and Platted on the South part of it.

C. W. Joiner - - {Seal}
Alvin Joiner - - {Seal}

State of Michigan County of Lake } ss.
 We the undersigned Charles W. Joiner as Surveyor & Orlando F. Phillips as Register of Deeds do hereby certify that we have carefully compared the annexed plat with the original plat of the Village of Chase in said County of Lake, that it is an exact duplicate thereof and the whole of such map or plat written our hands this 12th day of August - A. D. 1881

C. W. Joiner Surveyor
Orlando F. Phillips Register of Deeds

Registers Office }
 County of Lake }

Received for record the 12th day of August A. D. 1881
 at 3 o'clock P.M.

Orlando F. Phillips Register

13671