

94 OK  
10/1/29

# Thompson's Annex

Part of SE 1/4 of Section 35 T18N R12W  
LAKE COUNTY MICHIGAN

24905

Examined and Approved  
Oct 18-1929  
Geo. S. Spencer

### Dedication

Know all men by these presents That I  
Lee Dan Thompson, a single man, as proprietor have  
caused the land embraced in the annexed plat to  
be laid out and platted to be known as  
"Thompson's Annex" part of the S.E. 1/4 Section 35  
T18N R12W LAKE COUNTY MICH. and that  
the streets, alleys, and parks as shown on said plat  
are here by dedicated to the use of the public.

Signed by Sealed Lee Dan Thompson 2.S.  
in presence of Edna M. Thompson  
State of Illinois SS.  
County of Cook

On this 28th day of October 1929 before me  
a Notary Public in and for said county personally came  
the above Lee Dan Thompson known to me  
to be the same person who executed the above dedication  
and acknowledged the same to be his own free act and deed  
as such proprietor L. D. Thompson My commission expires September 11th 1930 Albany, Mich.

Description of Land platted  
The land embraced in the annexed plat of Thompson's Annex  
is described as follows:-  
Beginning of the 1/2 post on the south side section 35 T18N R12W  
Lake Co Mich;  
Thence N 1/2 S.E. 660ft Thence S 89° E 660ft  
Thence S 1/2 S.W. 660ft Thence N 89° W 660ft  
to point of beginning

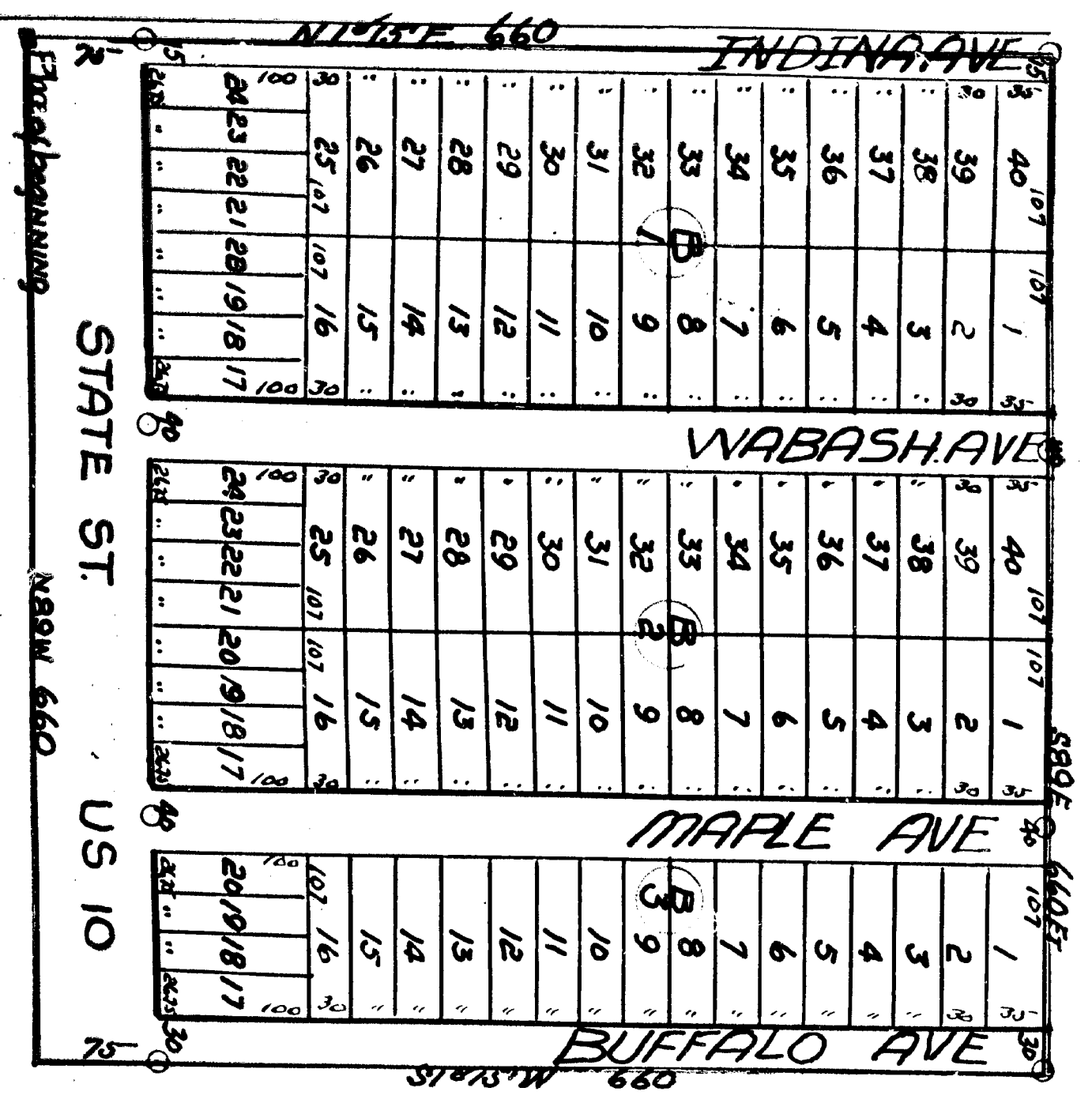

Treasurer's Certificate  
Office of County Treasurer, Lake Co Mich.  
I hereby certify that there are no tax liens or titles  
held by the State on the lands described and  
that there are no tax liens or titles held by  
individuals on said lands for the five years  
preceding the 11th day of October 1929  
and that the taxes for said period of five years  
are all paid as shown by the records of this office  
Walter B. Baird County Treasurer

Debet Baldwin this 14 day of October 1929  
Surveyor's certificate  
I hereby certify that the plat herein delineated is a correct one  
and that permanent metal monuments of not less than one  
inch in diameter and fifteen inches in length set in concrete  
base no less than four inches in diameter and forty-eight inches  
in length have been placed at all points marked 'O'  
as there are shown in all angles in the boundaries of the land  
platted or all intersections of streets, intersections of alleys, or streets  
and alleys and the intersection of streets and alleys of the boundaries  
of the plat as shown on said plat  
Walter B. Baird Surveyor

### Certificates of Approval

Municipal  
This plat was approved by the township board of the  
Township of Oshtemo Valley on the 10 day of  
October 1929  
Geo. O. Blum Township Clerk

County board  
This plat was approved on the 14 day of October 1929  
Franklin B. Smith Judge of probate  
Walter B. Baird County Clerk  
Walter B. Baird County Treasurer

Examined and Approved  
This 18th day of October 1929  
Walter B. Baird State Highway Comm.

Table  
Thompson's Annex  
Oct 27 2  
Oct 28 7  
Oct 29 7  
Oct 30 1929  
Geo. S. Spencer

1" = 100 ft  
All dimensions origin  
feet or decimal's thereof